

212 Bridge Street

E. Syracuse, New York 13057

SHOVEL READY APPROVED AUTO DEALERSHIP AND DETAIL SHOP

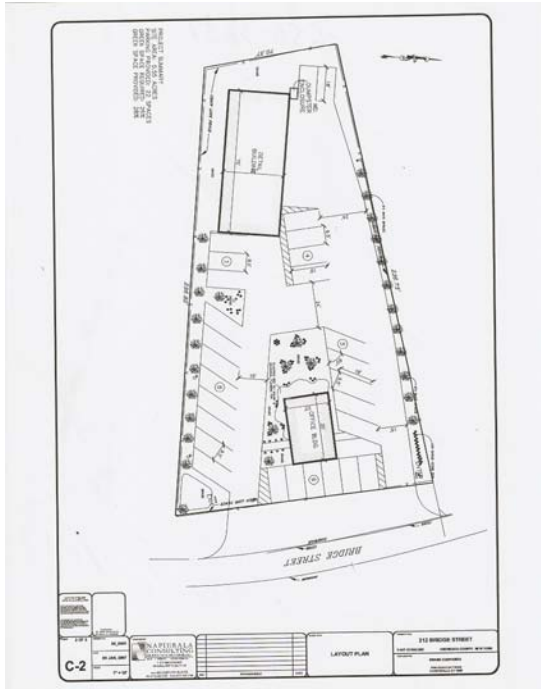

- LOCATION:** Situated across from BJ's Wholesale, Staples & Dunkin Donuts. Close to Wal-Mart, Napa, Aldi Grocery Store, The Tractor Supply Co., Beacon Federal Credit Union, restaurants and more...
- SQ.FT. AVAIL.:** (2) separate buildings:
Sale Office: 800 sf
Detail Shop: 2,400 sf
- SITE:** Approx.: .85 acres
- ZONE:** General Commercial
- FEATURES:** Approved Site Plan for Automobile Sales and Detail Shop. Exceptional exposure to Bridge Street and Manlius Center Rd. Site Grading and Drainage complete. Development potential.

TRAFFIC COUNTS:
 Bridge Street:
28,938 AADT/2006

Manlius Center Rd. (Rte 290)
17,234 AADT/2006

Bridge Street (over bridge to E. Syracuse):
16,418 AADT/2006

I690:
85,161, AADT/2006

FOR SALE / LEASE



View additional property information on our website at www.brangco.com

All information furnished, regarding property for sale, rental or financing is from sources deemed reliable, but no warranty or representation is made to the accuracy thereof and same is submitted subject to errors, change of price, rental or conditions prior to sale, lease or financing or withdrawal without notice.